

## CARBON STEEL GLOBE VALVE WITH BELLOW PN40 ICP DIN 3202-1 F1

Carbon steel globe valve with bellow flanged PN40 for no corrosive fluids, steam, hydrocarbons and thermic fluid.  
Stainless steel bellow and stainless steel + graphite gasket.  
Anti-turn device to avoid the risk of torsion of bellows.  
Pressure equalizing plug in DN200  
Bolted bonnet and packing for an easy maintenance.  
Compatible with explosive atmosphere, ATEX Zone 1&21 and Zone 2&22.

**Certificate**  
**3.1**



**Size :** DN15 to DN200  
**Connection :** Flanged PN40 RF  
**Min Temperature :** -29°C  
**Max Temperature :** +400°C  
**Max Pressure :** 40 bars  
**Specifications :** Non rising stem  
Stainless steel bellow  
Bolted bonnet and packing

**Materials :** Carbon steel EN 1.0619

CARBON STEEL GLOBE VALVE WITH BELLOW PN40 ICP DIN 3202-1 F1

**SPECIFICATIONS :**

- Respect the flow direction indicated by the arrow
- Non rising stem
- Bolted bonnet and gland pack
- Stainless steel bellow
- Pressure equalizing plug in DN200
- Pressed seat in the body
- Anti-turn device to avoid the risk of torsion of bellows
- Flanges R.F. PN40
- RAL 5002 blue painting, 40μ thickness

**USE:**

- No corrosive or no toxic fluids, steam, hydrocarbons, thermic fluid
- Min and max Temperature Ts : - 29°C to + 400°C
- Max Pressure Ps : 40 bars ( see graph under )
- Δp 20 bars max for DN125, 15 bars max for DN150, 19 bars max for DN200
- Keep greased the stem

**FLOW COEFFICIENT Kvs ( M3 / h ) :**

| DN           | 15  | 20 | 25 | 32 | 40 | 50 | 65 | 80  | 100 | 125 | 150 | 200 |
|--------------|-----|----|----|----|----|----|----|-----|-----|-----|-----|-----|
| Kvs ( m3/h ) | 3.8 | 7  | 10 | 19 | 35 | 43 | 60 | 110 | 146 | 210 | 300 | 670 |

**PRESSURE / TEMPERATURE GRAPH :**

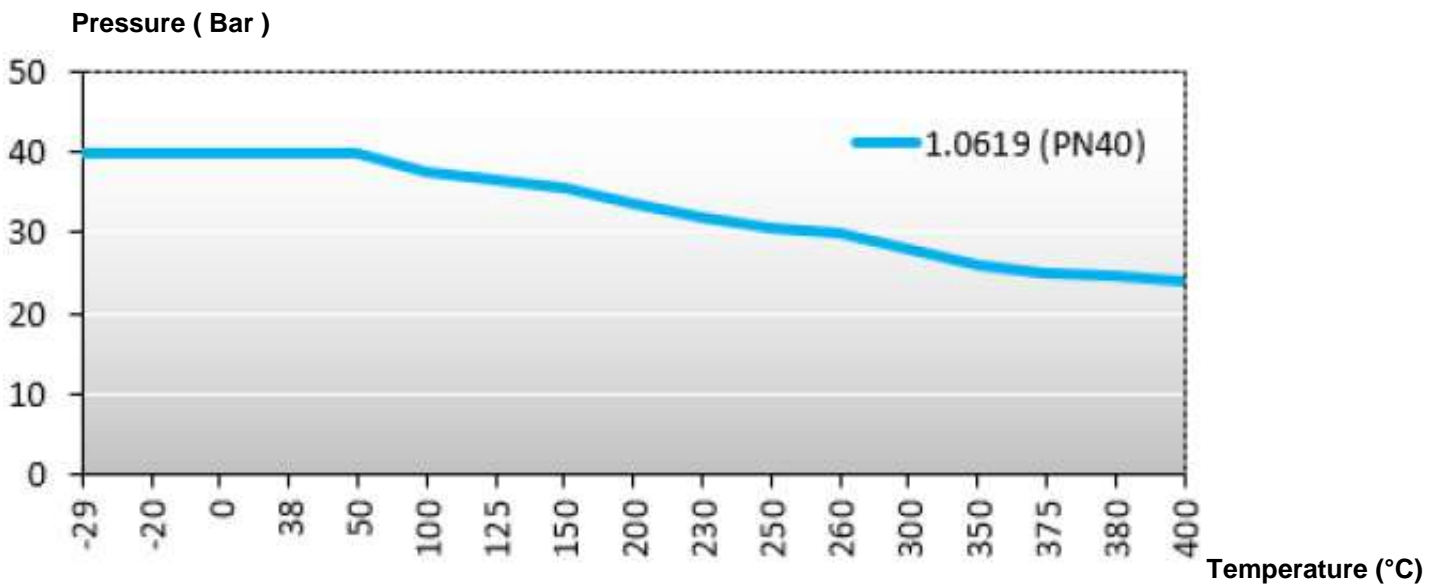

**RANGE :**

- Carbon steel globe valve with stainless steel bellow flanged R.F. PN40 from DN 15 to DN 200 Ref. 475

**CARBON STEEL GLOBE VALVE WITH BELLOW PN40 ICP DIN 3202-1 F1**

**MATERIALS DN15-150 :**

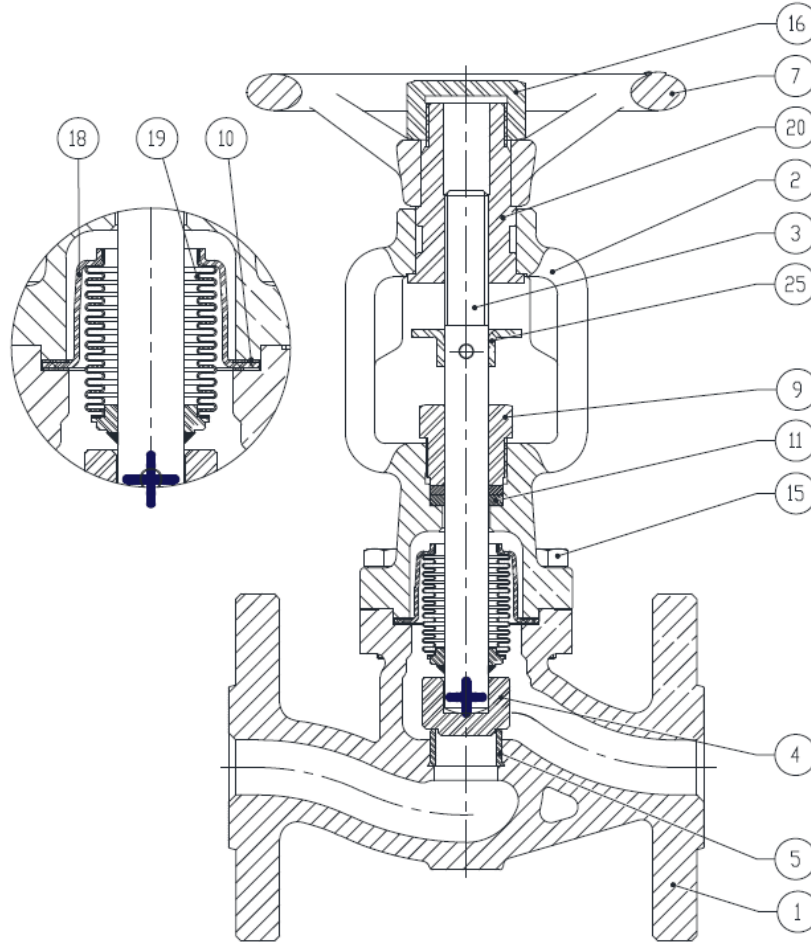

| Item | Designation      | Materials               |
|------|------------------|-------------------------|
| 1    | Body             | EN 1.0619               |
| 2    | Bonnet           |                         |
| 3    | Stem             | AISI 304 ( 1.4301 )     |
| 4    | Disc             | AISI 420 ( X20 Cr13 )   |
| 5    | Seat             | X4 CrNi 13 4 (CA6NM)    |
| 7    | Handwheel        | ASTM A216 WCB           |
| 9    | Gland            | Steel 1.1191 + ZP       |
| 10   | Gasket           | Graphite                |
| 11   | Packing          |                         |
| 15   | Screw            | A193 B7M                |
| 16   | Handwheel nut    | Steel 1.1191 + ZP       |
| 18   | Hood             | AISI 304 ( 1.4301 )     |
| 19   | Bellows          |                         |
| 20   | Threaded bushing | Steel 1.1191 +HT65+ ENP |
| 25   | Anti turn device | Steel S235 JR+ZP        |
|      | Lubricator       | Brass                   |

**CARBON STEEL GLOBE VALVE WITH BELLOW PN40 ICP DIN 3202-1 F1**

**MATERIALS DN200 :**

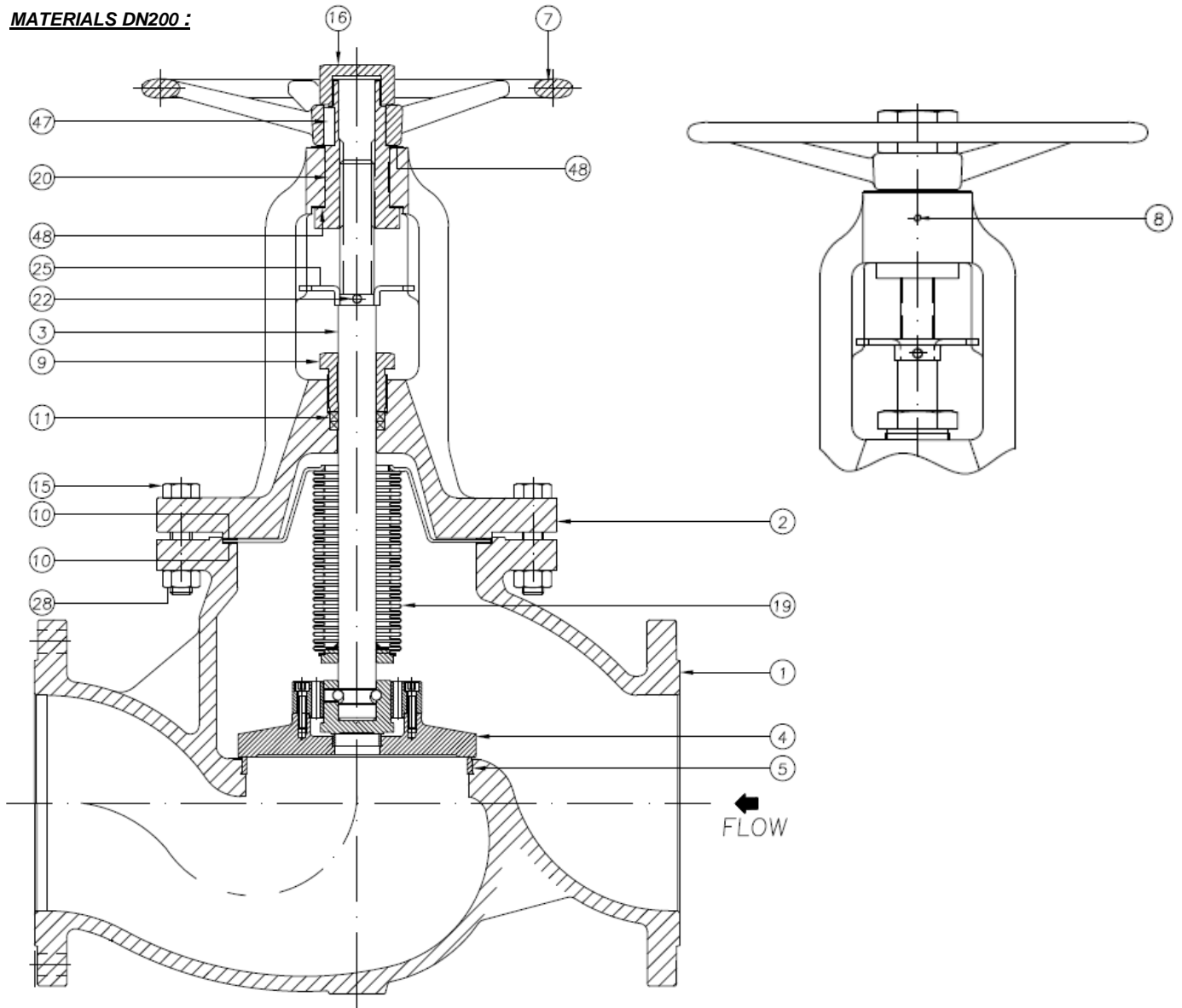



| Item | Designation  | Materials             |
|------|--------------|-----------------------|
| 1    | Body         | EN 1.0619             |
| 2    | Bonnet       |                       |
| 3    | Stem         | AISI 304 ( 1.4301 )   |
| 4    | Disc         | AISI 420 ( X20 Cr13 ) |
| 5    | Seat         | X4 CrNi 13 4 ( CA6NM) |
| 7    | Handwheel    | ASTM A216 WCB         |
| 8    | Grease nipp. | Steel                 |
| 9    | Gland nut    | Steel 1.1191 + ZP     |
| 10   | Gasket       | Graphite              |

| Item | Designation      | Materials           |
|------|------------------|---------------------|
| 11   | Packing          | Graphite            |
| 15   | Screw            | A193 B7M            |
| 16   | Handwheel nut    | EN 10087            |
| 19   | Bellow           | AISI 304 ( 1.4301 ) |
| 20   | Threaded bushing | EN 10087            |
| 22   | Pin              | Steel               |
| 25   | Anti turn device | EN 10025            |
| 28   | Nut              | A194 2HM            |
| 47   | Key              | Steel               |
| 48   | Washer           | Steel               |

**CARBON STEEL GLOBE VALVE WITH BELLOW PN40 ICP DIN 3202-1 F1**

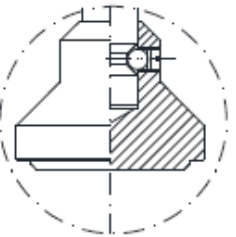
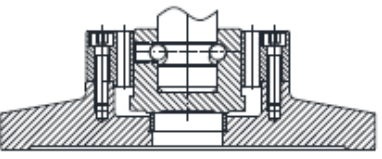
DISC OPTIONS :

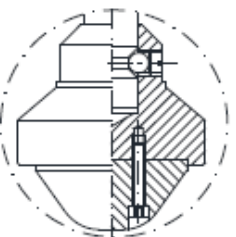
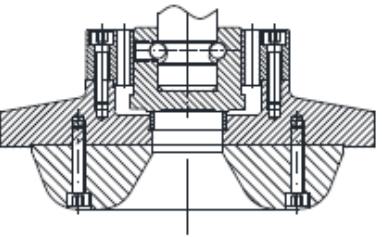
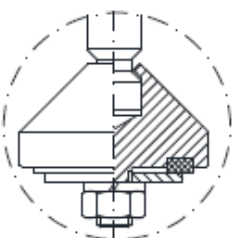
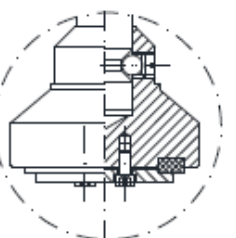
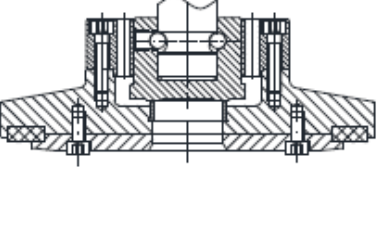
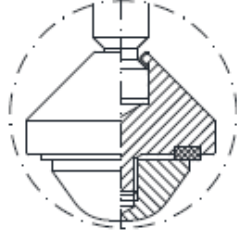
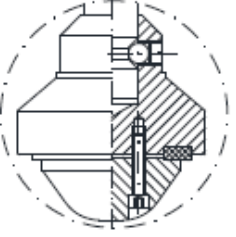
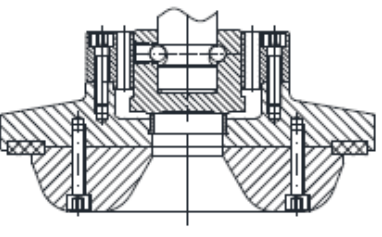
| DN 15-65  | DN 80-150   | DN 200   |
|---|---|--|
| <b>STANDARD DISC</b>  |   |  |
|    |    |    |
| <b>OPTION A : THROTTLING PLUG*</b>  |   |  |
|   |   |   |
| <b>OPTION B : DISC WITH SOFT SEAT*</b>  |   |  |
|  |  |  |
| <b>OPTION C : THROTTLING PLUG + SOFT SEAT*</b>                                      |   |  |
|  |  |  |

\* :ON REQUEST

**CARBON STEEL GLOBE VALVE WITH BELLOW PN40 ICP DIN 3202-1 F1**

**SIZE ( in mm ) :**

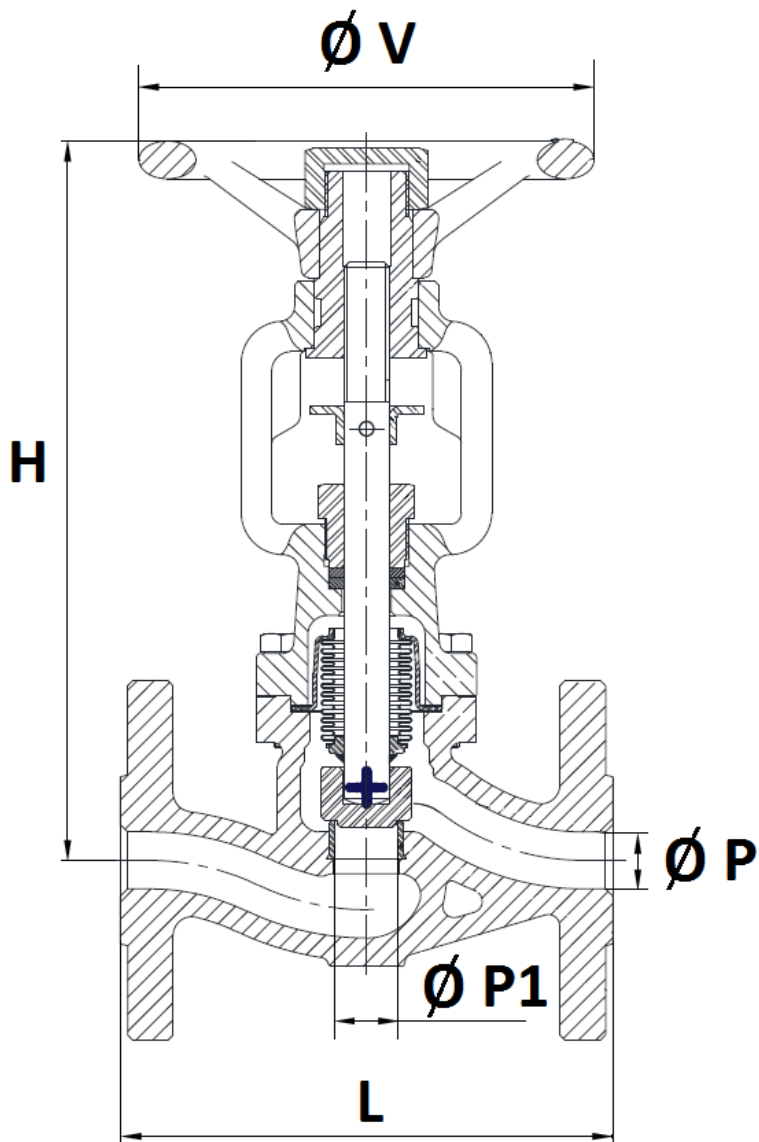

| DN          | 15     | 20     | 25     | 32     | 40     | 50     | 65     | 80     | 100    | 125    | 150    | 200    |
|-------------|--------|--------|--------|--------|--------|--------|--------|--------|--------|--------|--------|--------|
| L           | 130    | 150    | 160    | 180    | 200    | 230    | 290    | 310    | 350    | 400    | 480    | 600    |
| Ø P         | 15     | 20     | 25     | 32     | 40     | 50     | 65     | 80     | 100    | 125    | 150    | 200    |
| Ø P1        | 16.5   | 20.5   | 25.2   | 30     | 40.8   | 50.5   | 66     | 81     | 104.5  | 126    | 150.5  | 205    |
| H           | 190    | 195    | 220    | 219    | 256    | 265    | 328    | 341    | 376    | 488    | 531    | 685    |
| Ø V         | 120    |        | 140    |        | 180    |        | 200    |        | 250    | 400    |        |        |
| Weight (Kg) | 3.7    | 4.8    | 6.8    | 7.8    | 13     | 15.5   | 23     | 28     | 43     | 68     | 100    | 202    |
| Ref.        | 475015 | 475020 | 475025 | 475032 | 475040 | 475050 | 475065 | 475080 | 475100 | 475125 | 475150 | 475200 |

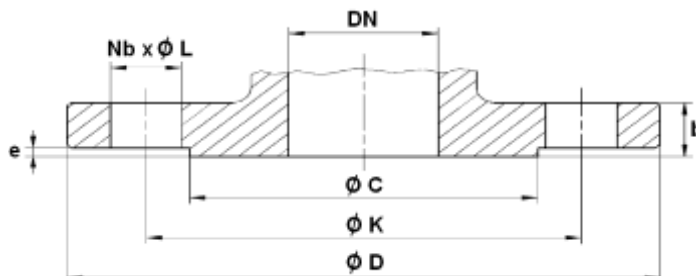
**CARBON STEEL GLOBE VALVE WITH BELLOW PN40 ICP DIN 3202-1 F1**
**FLANGES SIZE ( in mm ) :**

| DN       | 15     | 20     | 25     | 32     | 40     | 50     | 65     | 80     | 100    | 125    | 150    | 200     |
|----------|--------|--------|--------|--------|--------|--------|--------|--------|--------|--------|--------|---------|
| Ø C      | 45     | 58     | 68     | 78     | 88     | 102    | 122    | 138    | 162    | 188    | 218    | 285     |
| Ø D      | 95     | 105    | 115    | 140    | 150    | 165    | 185    | 200    | 235    | 270    | 300    | 375     |
| Ø K      | 65     | 75     | 85     | 100    | 110    | 125    | 145    | 160    | 190    | 220    | 250    | 320     |
| Nb x Ø L | 4 x 14 | 4 x 14 | 4 x 14 | 4 x 18 | 4 x 18 | 4 x 18 | 8 x 18 | 8 x 18 | 8 x 22 | 8 x 26 | 8 x 26 | 12 x 30 |
| b        | 16     | 18     | 18     | 18     | 18     | 20     | 22     | 24     | 24     | 26     | 28     | 34      |
| e        | 2      | 2      | 2      | 2      | 3      | 3      | 3      | 3      | 3      | 3      | 3      | 3       |

**STANDARDS :**

- Manufacturer certified ISO 9001 :2015
- DIRECTIVE 2014/68/EU : For liquids and gas of Group 1
  - DN15-25 : Article 4, §3 (SEP), no CE marking
  - DN32-100 : Risk Category II, CE1035 or CE0035 marking
  - DN125-200 : Risk Category III, CE1035 or CE0035 marking
- Certificate 3.1 on request
- Designing according to DIN 3840
- Marking according to EN 19
- Pressure Tests according to EN 12266-1, Rate A
- Length according to EN 558 series 1 ( DIN 3202-1 F1 )
- Flanges R.F. according to EN 1092-1 PN40
- ATEX Group II Category 2 G/2Dc Zone 1 & 21 Zone 2 & 22 ( optional marking ) according to directive 2014/34/EU

**ADVICE :** Our opinion and our advice are not guaranteed and SFERACO shall not be liable for the consequences of damages. The customer must check the right choice of the products with the real service conditions.